

Northeast Iowa Community College

John Deere TECH

Program Information



JOHN DEERE

**Northeast Iowa Community College
Calmar Campus
John Deere TECH Program**

Table of Contents

Introduction	1
John Deere Instructors	2
Responsibilities of Participants	
Northeast Iowa Community College	3
John Deere Company	3
John Deere Dealership	4
Student	4
Admissions Requirements	5
Finding a Sponsor	6
Dealer Approval Form.....	7
Curriculum	
Sequence of Classes.....	8
General Education Requirements	9
Course Descriptions	10-13
Required Tool List	14-15
Calmar Campus Map	16
Program Forms.....	17-18
Supervised Occupational Experience Training Agreement	
Class Attendance Policy	

P.O. Box 400
Calmar, IA 52132
844-642-2338
www.nicc.edu

Northeast Iowa Community College
Calmar Campus
John Deere TECH Program

The John Deere TECH program is an educational program designed to upgrade the technical competence and professional level of the incoming farm equipment dealership technician. The program is supported by John Deere Company and operated by **Northeast Iowa Community College**, Calmar Campus. Students will be provided with classroom lecture and laboratory experiences on John Deere products at the Calmar Campus and a unique opportunity to work at a John Deere dealership.

The total program is completed in four semesters and one summer term or approximately 21 months. Each specialized subject is studied in the classroom and laboratory on campus and then followed by related work experience in a dealership. For example, the first semester involves a number of courses, followed by 12 weeks at the dealership experience. The work experience at the dealership should relate as much as possible to the course work just completed in school. Classroom instruction will cover the basics, as well as the latest developments in all of John Deere agricultural and consumer products.

Since considerable time is spent at the dealership, the program requires the student to have a sponsoring John Deere dealer. If necessary, the student can request assistance in locating a sponsoring dealer. The main responsibility of the dealership is to provide training-related employment for the student during the work experience periods.

John Deere TECH Program Instructors

Duane Bouska - Graduated from Northeast Iowa Technical Institute Farm Implement Mechanics Program. Eighteen years as a service technician at John Deere dealerships. Extensive John Deere training, NC3 Training Instructor, OSHA and Stihl. John Deere Certified Master Instructor. [**Extension 1385; bouskad@nicc.edu**]

Rodney Necker - Graduated from Northeast Iowa Technical Institute Farm Implement Mechanics Program. Continued coursework from NICC. Twelve years experience as a service technician and 13 years as service manager at a John Deere dealership. Extensive John Deere training. [**Extension 1386; neckerr@nicc.edu**].

Neil Grube - Graduated from Area One Technical Institute Farm Implement Mechanics Program. Eleven years experience as service technician and twelve years as service manager at John Deere dealerships. Extensive John Deere training. [**Extension 1392; gruben@nicc.edu**]

Matt Johnson – Graduated from NICC John Deere TECH Program. Fourteen years experience as a service technician. Through John Deere training courses has earned certifications in John Deere Electrical, Hydraulics, Service Advisor and earned a Master Level Technician Certification. [**Extension 1289; johnsonma@nicc.edu**]

**Northeast Iowa Community College
Calmar Campus
John Deere TECH Program**

Responsibilities of Participants

Northeast Iowa Community College

- Maintain a current curriculum approved by John Deere.
- Provide a dedicated classroom and laboratory.
- Provide a John Deere trained instructor. (Instructor will act as liaison between the school and John Deere Company and will serve on John Deere TECH Advisory Committee.)
- Provide equipment and tools.
- Promote, advertise, and recruit qualified student candidates.
- Test applicants and assist dealers with student selection for the program.
- Maintain all student records.
- Provide customary student services such as academic advisement, financial aid, counseling, etc.
- Conduct student visitations during occupational experience semesters.
- Work with the dealership training coordinator to assure attainment of work experience competencies.
- Furnish program information to the public when requested.
- Provide dealer orientation during first term of program.

John Deere Company

- Encourage dealer cooperation and support.
- Provide special training for John Deere TECH instructor/coordinator.
- Furnish school with John Deere training equipment (manuals, components, essential tools, complete machines).
- Provide school with essential training materials (including technical publications and training aids).
- Oversee and participate in student selection procedure.
- Oversee and participate in instructor/coordinator selection procedure (individual subject to Deere approval).
- Monitor all phases of John Deere TECH to assure success.

John Deere Dealership

- Indicate interest in being a sponsoring dealer, so dealership name can be made available to interested students.
- Interview and select student that dealership will sponsor.
- Appoint an in-dealership coordinator to assist the school's John Deere TECH instructor/coordinator in planning and monitoring the cooperative work experience.
- Provide appropriate work experience which reinforces the trainee's most recent classroom instruction.
- Provide the new student/employee with five technician dealership apparel uniform shirt. The student's name should be included on the shirts, and uniforms remain property of the dealership.
- Provide the new student/employee with one black polo dress shirt with the green and yellow logo and can include dealership name on it.
- A winter jacket should also be provided.

Student

- Meet specified admission and academic requirement established by John Deere.
- Obtain and maintain sponsorship with John Deere dealership.
- Maintain academic standards and adhere to academic policies (minimum 2.0 GPA).
- Maintain attendance standards according to college policy.
- Wear uniforms and safety glasses while on campus and during cooperative work experiences at the dealership.
- Participate in all learning activities at the scheduled times.
- Provide sponsoring dealer with responsible and productive employment.
- Be responsible for program costs: tuition, fees, books, and tools.
- Complete required WBT's (Web Based Training Modules)
- Complete John Deere Certifications in Electric, Hydraulic, & Service Advisor



JOHN DEERE TECH

Program Highlights

- In addition to classroom lectures, you will participate in hands-on lab experiences and receive six months on the job training.
- Graduate with Hydraulics, Electrical and Service Advisor certificates endorsed by the John Deere company.
- Master the use of computer diagnostics, high-tech electronics and proprietary John Deere systems.



JOHN DEERE

John Deere Dealer Sponsor

Applicants are required to complete a sponsorship interview with an authorized John Deere Dealer Representative. Upon dealer approval, the student must submit the completed Dealer Approval form, found on the back of this sheet, to the Northeast Iowa Community College Admissions Office. Acceptance to the program will not be granted until all admission requirements are satisfied.

Admission Requirements

- Complete an application for admission at www.nicc.edu/apply
- Submit official high school transcripts.
- Schedule admission testing if ACT® testing was not completed or submit official college transcripts.
- Secure a John Deere dealer sponsor.

Program Costs	JOHN DEERE TECH	
Tuition/Fees	\$16,116 in-state*	\$18,012 out-of-state*
Tool/Supply Fee	\$5,055	
Books	\$2,800	
TOTAL	\$23,971 in-state	\$25,867 out-of-state

The costs above are provided as a guide to financing your John Deere TECH education. The costs provided are estimated at time of publication and do not reflect the exact cost a student may incur.

* Based on the 2021-2022 tuition and fee rates.

Learn More.

Calmar Admissions

844.642.2338, ext. 1307
admissions@nicc.edu

John Deere TECH Faculty

Duane Bouska
844.642.2338, ext. 1385
bouskad@nicc.edu

Rodney Necker
844.642.2338, ext. 1386
neckerr@nicc.edu

Neil Grube
844.642.2338, ext. 1392
gruben@nicc.edu

Matt Johnson
844.642.2338, ext. 1289
johnsonma@nicc.edu

**Northeast Iowa Community College
Calmar Campus
John Deere TECH Program**

Finding a Sponsor

Note: You may speak to any dealership at any time about the John Deere TECH Program. You are accepted into the program only after official acceptance occurs, after all assessments, applications and dealer sponsorship forms have been approved by Northeast Iowa Community College and John Deere.

Key points to remember:

- John Deere dealerships are independent businesses. They are not employees of John Deere.
- When looking for a sponsor, you are looking for a job.
- Northeast Iowa Community College and the John Deere Training Center will provide limited assistance in giving guidance and identifying interested dealerships.
- We do not assign you a sponsor.
- As a John Deere TECH student you will be an employee and a student, although the two should never conflict.
- Some dealers may choose not to participate.
- The **interview** - Call ahead for an appointment.
- Be prepared:
 - Be neat and clean in appearance
 - Be confident of your goals and skills
 - Complete your part of the John Deere TECH application as neatly as possible before the interview.
- Your first priority should be convincing the dealer that you will make a good employee.
- You may speak to the Dealer (owner), General Manager, or Service Manager.
- If you aren't sure who to see, ask for the Dealer first, then the Service Manager.

If you are sure you want to be in the John Deere TECH program, be confident and get busy right now. Don't be discouraged if your first attempt doesn't land you a sponsor.

JOHN DEERE DEALER SPONSOR

Sponsor Interview

The purpose of the dealer sponsorship is to provide on-the-job training for students. The dealer sponsorship and student relationship is much like an employer/employee relationship. Treat your sponsorship interview like a job interview. The dealer will be looking for qualities and skills they would like to see in a future employee.

Education and Experience

Prior training or experience is not essential for success in the John Deere TECH program, but may be valuable in certain instances.

Scholastic Aptitude

Dealers will want to learn more about your academic success. You may want to provide a copy of your high school transcript and other academic achievements to show your potential to complete the John Deere TECH degree requirements.

Commitment

John Deere TECH is approximately two years in length and you must be willing to make a commitment to complete all required courses and supervised occupational experiences.

Career Interest

Highlight your interest to be a reliable and knowledgeable John Deere TECH. The dealer is looking for someone they can see helping customer needs.

Northeast Iowa Community College is accredited by the Higher Learning Commission (HLC). It is the policy of Northeast Iowa Community College not to discriminate on the basis of race, color, national origin, sex, disability, age (employment), sexual orientation, gender identity, creed, religion, and actual or potential parental, family or marital status in its programs, activities, or employment practices as required by federal and state civil rights regulations. If you have questions, concerns or to read the full policy www.nicc.edu/nondiscrimination. All information is accurate at time of publication and is subject to change without notice.

05.2021 | MKT.LSS.ACD.Cluster.Auto.JDTech.ADM Req

John Deere TECH | Dealer Approval Form

Applicant's Name: _____ Telephone: (_____) _____ - _____

Address: _____ City: _____ State: _____ Zip: _____

- I recommend this applicant for the John Deere TECH program and agree to provide sponsorship.
- I DO NOT recommend this applicant for the John Deere TECH program.

Dealership: _____ Telephone: (_____) _____ - _____

Dealer Representative: _____ Title: _____

Address: _____ City: _____ State: _____ Zip: _____

I understand I must successfully complete coursework through Northeast Iowa Community College in order to maintain my eligibility for the cooperative requirements at my sponsoring dealership. I also understand the College must communicate relevant information about my academic process with my dealership to insure I remain eligible to complete this sponsorship program. I hereby grant permission to Northeast Iowa Community College to share copies of any transcripts, pre-admission assessment results, interview data, college grades, attendance information, academic progress reports and student account statements and information with my sponsoring dealership and their related corporations or companies.

Student Signature: _____ Date: _____

Return this completed form to: Northeast Iowa Community College
Attn: Admissions Office
P.O. Box 400
Calmar, IA 52132

**Northeast Iowa Community College
Calmar Campus
John Deere TECH Program
Sequence of Classes**

Term	Course Number	Course Name	Credits
1	AGM:531	John Deere AMS/Implement Technology	3.5
1	AGM:532	John Deere Fundamentals and Safety	3.5
1	AGM:534	John Deere Hydraulics I	3.5
1	AGM:536	John Deere Electrical/Electronics I	3.5
1	COM:723	Workplace Communications OR	3.0
1	ENG:105	Composition I	
1	SDV:179	The College Experience	3.0
		Term Total	20.0
2	AGM:543	John Deere Combines	4.0
2	AGM:807	John Deere Internship I	8.0
		Term Total	12.0
3	AGM:516	John Deere Heating and Air Conditioning	2.0
3	AGM:535	John Deere Hydraulics II	3.5
3	AGM:538	John Deere Power Train	5.5
3	PSY:111	Introduction to Psychology OR	3.0
3	PSY:112	Psychology of Human Relations	
		Term Total	14.0
4	AGM:544	John Deere Consumer Products/Engines	4.0
4	AGM:808	John Deere Internship II	8.0
		Term Total	12.0
5	AGM:504	John Deere Welding	1.0
5	AGM:537	John Deere Electrical/Electronics II	3.5
5	AGM:540	John Deere Diesel Engines	3.5
5	AGM:541	John Deere Diesel & Fuel Systems/Tractor	3.5
5	AGM:542	John Deere Information Technology	3.5
5	SPC:112	Public Speaking	3.0
5	*	Math/Science Elective	3.0
		Term Total	21
		Program Total	79.0

*Note: Prior to completion of the program, students are required to provide their program faculty with a copy of their First Aid/CPR certification.

**Northeast Iowa Community College
Calmar, Iowa
John Deere TECH Program**

General Education Requirements

Communications Elective (6 Credits) (Based on Accuplacer Score)
Composition I **OR** Workplace Communications **AND**
Public Speaking

Math/Science Elective (3 Credits)
MAT:102, MAT:773, MAT:744, transfer-level MAT, or transfer-level Science
Elective
Suggested Science courses include: ENV:115, ENV:140 or other transfer level
science electives

Social Science/Humanities Elective (3 Credits)
Introduction to Psychology **OR**
Psychology of Human Relations

**Northeast Iowa Community College
Calmar, Iowa
John Deere TECH Program**

Course Descriptions

AGM:516 John Deere Heating and Air Conditioning **2 Credits**
Theory of operation and repair of late model John Deere air conditioning, heating and ventilation systems. Equipment for refrigerant recovery/recycling of R134A will be used. Upon course completion the student will be certified under the MACS (Mobile Air Conditioning Society) Certification Training Manual.

AGM:531 John Deere AMS/Implement Technology **3.5 Credits**
Designed to give the student a better understanding of the basic operating principles of select John Deere implements. In a classroom setting, the student will study the theoretical operation of planters and balers. Basic information on belts, chains, bearings and seals will also be covered. The student will be given the opportunity to demonstrate setup and field adjustments for planters, round balers, sprayers, and associated AMS equipment.

AGM:532 John Deere Fundamentals and Safety **3.5 Credits**
This course is an entry-level course designed to cover basic aspects of the shop, shop safety, equipment, and tools. The students will get an introduction of Technical Manuals, Service Advisor, Parts Advisor and acronyms. They will also work with new machine predelivery, wheel moves, forklift and machine operation and machine disassemble.

AGM:504 John Deere Welding **1 Credit**
Theory and practice of oxyacetylene welding and cutting, including proper operation of equipment. Also included are the principles, safety, procedures, and application of arc and gas metal arc welding.

AGM:534 John Deere Hydraulics I **3.5 Credits**
This course will cover principles and applications of fluid power as it applies to John Deere equipment. Basic components and theory will covered in the classroom. Testing and diagnostic work will be applied using various pieces of John Deere equipment.

AGM:535 John Deere Hydraulics II **3.5 Credits**
This course will cover principles and applications of fluid power as it applies to John Deere equipment. The student will get an understanding of the circuits used and how to test and diagnose them as found on John Deere equipment. Service Advisor, gauges and flow-rators will be used.

AGM:536 John Deere Electrical/Electronics I**3.5 Credits**

Basic electrical principles and application of Ohm's Law, magnetism, electromagnetism, and the safe utilization of electrical test meters. Includes the design, construction, and safe testing of lead acid storage batteries. Reading of electrical schematics using JIC symbols as related to the ag industry.

AGM:537 John Deere Electrical/Electronics II**3.5 Credits**

This course will cover the principles of operation, testing, and repair of cranking systems, charging systems, Can Bus systems and control unit circuits, procedures and use of digital multimeters, techniques of circuit diagnosis, and reading of electrical schematics. Tractor circuits including lighting, accessory, Can Bus circuits, and gauges will be tested by the student.

AGM:538 John Deere Power Train**5.5 Credits**

The theory of Power Transmission from engine to traction wheels on John Deere tractors will be discussed. This includes the function and operation of gears, clutches, planetary gear sets, differentials, mechanical front wheel drive systems and hydrostats. The course will cover the diagnosis, repair and adjustment of John Deere syncro-range, quad-range, infinitely variable and power-shift transmissions.

AGM:540 John Deere Diesel Engines**3.5 Credits**

This course covers the repair of the John Deere diesel engine. Operation and service of the primary parts will be discussed in the class. The student will be given the opportunity to disassemble, measure and inspect a live John Deere diesel engine. After the inspection, the engine will be reassembled and then started to assure student competence.

AGM:541 John Deere Diesel Fuel Systems/Tractor Performance**3.5 Credits**

This course will familiarize the student with the fuel injection pumps and HPCR systems used on John Deere engines. Time will be spent on making the student aware of maintenance procedures for proper removal, installation, and timing of fuel injection pumps and also testing and repair of nozzle components and filtering systems. Included will be dynamometer operation related to engine performance.

AGM:542 John Deere Information Technology**3.5 Credits**

John Deere technicians are required to use several sources of information and technology during the daily operations of their job. Service ADVISOR, Parts ADVISOR, and Dealer Path programs are computer based software that provides technical information for current and non-current John Deere models of equipment. This class will prepare students to take the John Deere Service Advisor Certification test and will expose them to Parts ADVISOR and Dealer Path. Final Tier 4 emission training will be incorporated within the course to facilitate practical application of Service ADVISOR.

AGM:543 John Deere Combines**4.0 Credits**

This course is designed to give the student a better understanding of the basic operating principles of the John Deere combine. Operation and adjustment as well as combine drive systems will be covered in a classroom setting. Hands-on training of various combine components will be done in a lab setting

AGM:544 John Deere Consumer Products/Engines**4.0 Credits**

Designed to give the student a better understanding of the basic 2 and 4-cycle engine operation, repair, and adjustments. Repair procedures and adjustments of gas and diesel engines will be covered in the classroom setting. Engine tear down, operation, and basic diagnostics will be done in a lab setting.

AGM:807 John Deere Internship I**8 Credits**

The student will receive on-the-job experience in a John Deere Dealership. This will allow the student to practice and utilize the skills and knowledge learned previously. This work experience will be supervised by the Northeast Iowa Community College John Deere Tech Instructors.

AGM:808 John Deere Internship II**8 Credits**

The second on the job experience will allow the student to enhance their skills learned from the previous OJT and school semester. It is expected that they will enhance the relationships and work efficiency developed at the dealership. This work experience will be supervised by the Northeast Iowa Community College John Deere Tech instructor.

COM:723 Workplace Communications**3 Credits**

This course provides the opportunity for students to develop as competent employees through instruction and practical application of communication skills expected in the work environment. Emphasis is placed on listening, speaking, and writing skills as they relate to the career needs of the students. This course is geared primarily to students in Associate of Applied Science programs.

ENG:105 Composition I**3 Credits**

A writing course that prepares the student for the types of communication and thought essential to academic and working-world success. The course focuses on writing as a process and is intended to help students identify and refine their own personal writing. Instruction includes basic research and documentation skills.

ENG:106 Public Speaking**3 Credits**

An introductory course designed to help students develop skills as speakers and critical listeners, increase understanding of the concepts and principles of verbal communication, and become more effective communicators in formal and informal speaking situations.

ENV:115 Environmental Science**3 Credits**

A study of the biological basis of environmental science and human influence on biosphere dynamics. Emphasis on scientific principles, inter-relationships among resources, pollution and environmental degradation, soil and water conservation, and the impact that politics, economics, ethics and the world view have on the future direction for life on the planet.

ENV:140 Natural Resource Conservation**4 Credits**

A study of the general principles of natural resource conservation with an emphasis on local conservation organizations, indigenous resources and typical management activities. Special consideration given to environmental preservation, recreational functions, conflicting utilization policies, and employment opportunities in natural resource conservation and management.

MAT:102 Intermediate Algebra**4 Credits** This

intermediate course reviews real numbers and polynomials. Topics studied are first-degree equations in two variables, rational expressions, exponents and radicals, quadratic equations, graphing functions and relations, systems of equations and inequalities. Prerequisite: A minimum grade of C- in MAT:063 or MAT:744 or qualifying placement score

MAT:773 Applied Math II**3 Credits**

A course in algebra and trigonometry for technicians. Topics include polynomials, equations and formulas, graphing linear equations, systems of linear equations, factoring quadratic equations and trigonometry. Prerequisite(s): A minimum grade of C- in MAT:772 or qualifying placement score.

MAT:744 Technical Math**4 Credits**

Technical Math introduces selected topics from algebra and trigonometry with everyday applications to the technical areas. Some of the topics presented include the solution of linear and quadratic equations, trigonometric functions, vectors, graphing, and equations. Prerequisite: A minimum grade of C- in MAT:063 or MAT:773 or qualifying placement score

PSY:111 Introduction to Psychology**3 Credits**

A survey of psychology including theoretical and experimental findings and applications from areas such as physiological, physiology, learning, memory, personality, social, abnormal, therapy, and health psychology.

PSY:112 Psychology of Human Relations**3 Credits**

Covers all types of interactions among people-their conflicts, cooperative efforts, and group relationships. It is the study of those beliefs, attitudes, and behaviors that cause interpersonal conflict in our personal lives and in work-related situations.

TOOL LIST: John Deere TECH

All items listed below are required.

REQUIRED SUPPLIES

1/4" DRIVE

- 1 set shallow 5 - 15MM - 6pt
- 1 set deep 5 - 15MM - 6pt
- 1 set shallow 3/16" - 9/16" - 6pt
- 1 set deep 3/16" - 9/16" - 6pt
- 1 each- ratchet
- 1 each- driver handle
- 1 each- U-joint (swivel)
- 1 each- 1 1/4" extension
- 1 each- 2" extension
- 1 each- 4" extension
- 1 each- 6" extension
- 1 each- 8" extension
- 1 each- 11"

WRENCHES

- 1 set 8 - 24MM combination wrenches
- 1 each- 27MM combination wrench
- 1 each- 30MM combination wrench
- 1 each- 32MM combination wrench
- 1 set 5/16" - 1 1/4" combination wrenches
- 1 set 9 - 21MM flare nut wrench set
- 1 set 1/4" - 13/16" flare nut wrench set
- 1 set 1.5 - 10MM L shape hex wrench set
- 1 set 1/20" - 3/8" L shape hex wrench set
- 1 each- 12" adjustable wrench

3/8" DRIVE

- 1 set shallow 8 - 19MM - 6pt
- 1 set deep 8 - 19MM - 6pt
- 1 set shallow 1/4" - 7/8" - 6pt
- 1 set deep 1/4" - 7/8" - 6pt
- 1 each- ratchet
- 1 each- U-joint (swivel)
- 1 each- 1 1/2" extension
- 1 each- 3" extension
- 1 each- 4" extension
- 1 each- 6" extension
- 1 each- 8" extension
- 1 each- 11"
- 1 each- 5/8" spark plug socket
- 1 each 13/16" spark plug socket
- 1 each 3/4" flare nut socket

SCREWDRIVERS

- 1 each- #2 stubby phillips
- 1 each- #1 phillips - 3" shank w/ hex
- 1 each- #2 phillips - 4" shank w/ hex
- 1 each- #3 phillips - 6" shank w/ hex
- 1 each- stubby flat tip
- 1 each- flat tip - 3" shank w/ hex
- 1 each- flat tip - 4" shank w/ hex
- 1 each- flat tip - 6" shank w/ hex
- 1 each- flat tip - 8" shank w/ hex
- 1 each- ratcheting screwdriver

1/2" DRIVE

- 1 set shallow (12 - 24MM - 12pt)
- 1 set shallow (3/8" - 1 5/16" - 12pt)
- 1 each- ratchet
- 1 each- 18" breaker bar
- 1 each- U-joint (swivel)
- 1 each- 5" extension
- 1 each- 11" extension

PLIERS

- 1 each- 8" slip joint pliers
- 1 each- 10" channel lock pliers
- 1 each- 7" needle nose pliers
- 1 each- 7" diagonal cutter
- 1 each- wire type hose clamp pliers
- 1 each- wire stripper/crimping tool
- 5 piece set - snap ring pliers
- 1 each- 3/32" wide ends w/ 1/8" diameter
- Tips X 90° angle snap ring pliers
- 1 each- 10" curved jaw locking pliers

ADAPTORS

- 1 each- 1/4" internal drive x 3/8" external drive
- 1 each- 3/8" internal drive x 1/2" external drive
- 1 each- 1/2" internal drive x 3/4" external drive
- 1 each- 3/8" internal drive x 1/4" external drive
- 1 each- 1/2" internal drive x 3/8" external drive
- 1 each- 3/4" internal drive x 1/2" external drive

GAUGES

- 1 set .006" - 0.30" bent feeler gauges
- 1 set .0015" - .035 flat feeler gauges
- 1 each- US thread pitch gauge
- 1 each- Metric thread pitch gauge
- 1 each- thread depth gauge
- 1 each- tire pressure gauge 2-100 psi capacity in 1/2 psi increments

HEX & TORX SOCKETS

- 1 set T8 - T55 TORX socket set
- 1 set 4 - 14MM hex socket set
- 1 set 1/16" - 3/8" hex socket set

TORQUE WRENCHES

- 1 each- 1/4" drive 40-200in-lb
- 1 each- 3/8" drive 20 - 100ft-lb
- 1 each- 1/2" drive 40 - 250-ft-lb

PUNCHES & CHISELS

- 1 each- 3/32 x 9/32 x 4 1/4" pin punch
- 1 each- 5/32" x 3/8" x 5" pin punch
- 1 each- 3/16" x 3/8" x 5 1/4" pin punch
- 1 each- 6" center punch
- 1 each- 3/8" x 5/16" x 5 1/2" chisel
- 1 each- 1/2" x 7/16" x 6" chisel
- 1 each- 5/8" x 1/2" x 6 1/2" chisel
- 1 each- 3/32" x 5/16" x 5 1/2" taper punch
- 1 each- 5/32" x 3/8" x 6" taper punch
- 1 each- 3/16" x 7/16" x 6 1/4" taper punch
- 1 each- 1/2" x 1/4" taper punch
- 1 each- 3/4" X 8" brass drift punch

PRY BARS

- 1 each- 6" rolling head pry bar
- 1 each- 12" rolling head pry bar
- 1 each- 16" rolling head pry bar
- 1 each- 20" rolling head pry bar
- 1 each- 8" striking pry bar
- 1 each- 12" striking pry bar
- 1 each- 18" striking pry bar
- 1 each- 24" striking pry bar

HAMMERS

- 1 each- 16oz dead blow ball peen hammer
- 1 each- 32oz dead blow ball peen hammer
- 1 each- 24oz dead blow soft face hammer
- 1 each- 48oz dead blow soft face hammer

BATTERY SERVICE TOOLS

- 1 each- side terminal cleaner
- 1 each- terminal brush
- 1 each- 5/16" battery terminal ratcheting wrench
- 1 each- angle nose battery pliers

FILES

- 1 each- 6" three square file
- 1 each- 8" round file
- 1 each- 8" mill file
- 1 each- 10" mill file

TOOL BOX

- 1 each- roll cab

30" X 55" MAXIMUM DIMENSIONS

MISCELLANEOUS TOOLS

- 1 each- blow tip with rubber tip
- 1 each- magnet (telescoping)
- 1 each- telescoping mirror
- 1 each- gasket scraper
- 1 each- rigid carbon scraper
- 1 set- 4 piece pick set
- 1 each- air chuck
- 1 each- Z87 safety glasses
- 1 each- hacksaw
- 1 each- pocket 6" steel ruler U.S./Metric
- 1 each- valve core removal tool
- 1 each- 25' tape measure
- 1 each- digital multi-meter (must be Fluke 115)
- 1 each- air conditioning duct thermometer
- 1 each- rechargeable pen light
- 1 each 0 – 4" individual micrometers

APPROXIMATE COST: \$5,000

LEARN MORE.

www.nicc.edu/jdtech



**NORTHEAST IOWA
COMMUNITY COLLEGE**

Northeast Iowa Community College is accredited by the Higher Learning Commission (HLC). It is the policy of Northeast Iowa Community College not to discriminate on the basis of race, color, national origin, sex, disability, age (employment), sexual orientation, gender identity, creed, religion, and actual or potential parental, family or marital status in its programs, activities, or employment practices as required by federal and state civil rights regulations. If you have questions, concerns or to read the full policy www.nicc.edu/nondiscrimination.

Financial Aid does not cover supply / tool expenses. Estimated cost will vary depending on brand you choose to purchase.

All information is accurate at time of publication and is subject to change without notice.

Duane Bouska
844.642.2338, ext. 1385
bouskad@nicc.edu

Matt Johnson
844.642.2338, ext. 1289
johnsonma@nicc.edu

Neil Grube
844.642.2338, ext. 1392
gruben@nicc.edu

Rodney Necker
844.642.2338, ext. 1386
neckerr@nicc.edu

CALMAR CAMPUS

1. Child Development Center

- Child Care
- Early Childhood Classrooms (*Lower Level*)

2. Darwin L. Schrage Administration Building

- Boardroom
- Business Office

3. Student Center

- Assessment Testing Center
- Bookstore
- Disability Services
- Cafeteria
- Learning Center
- Library
- Student Services
(*Admissions, Advising, Career Services, Compliance, Counselor, Financial Aid, Registrar, Student Life*)

4. Max Clark Hall

- Arts and Sciences
- Business Programs
- Cosmetology Program & Salon
- Health Programs
- Computer Labs

5. Wilder Business Center

- Auditorium
- Computer Information Systems - Helpdesk
- Business and Community Solutions
- Online and Blended Learning
- Advancement, Foundation and Alumni Relations
- Print Center

6. Industrial Technologies Building

- Career and Technical Programs
- Maintenance and Deliveries

7. Ag Technologies Building

- John Deere TECH
- Welding
- Open Lab

8. Beef Education Facility

9. Iowa's Dairy Center

- Agriculture and Animal Science Programs
- Iowa's Robotic Dairy Center
- Science Labs

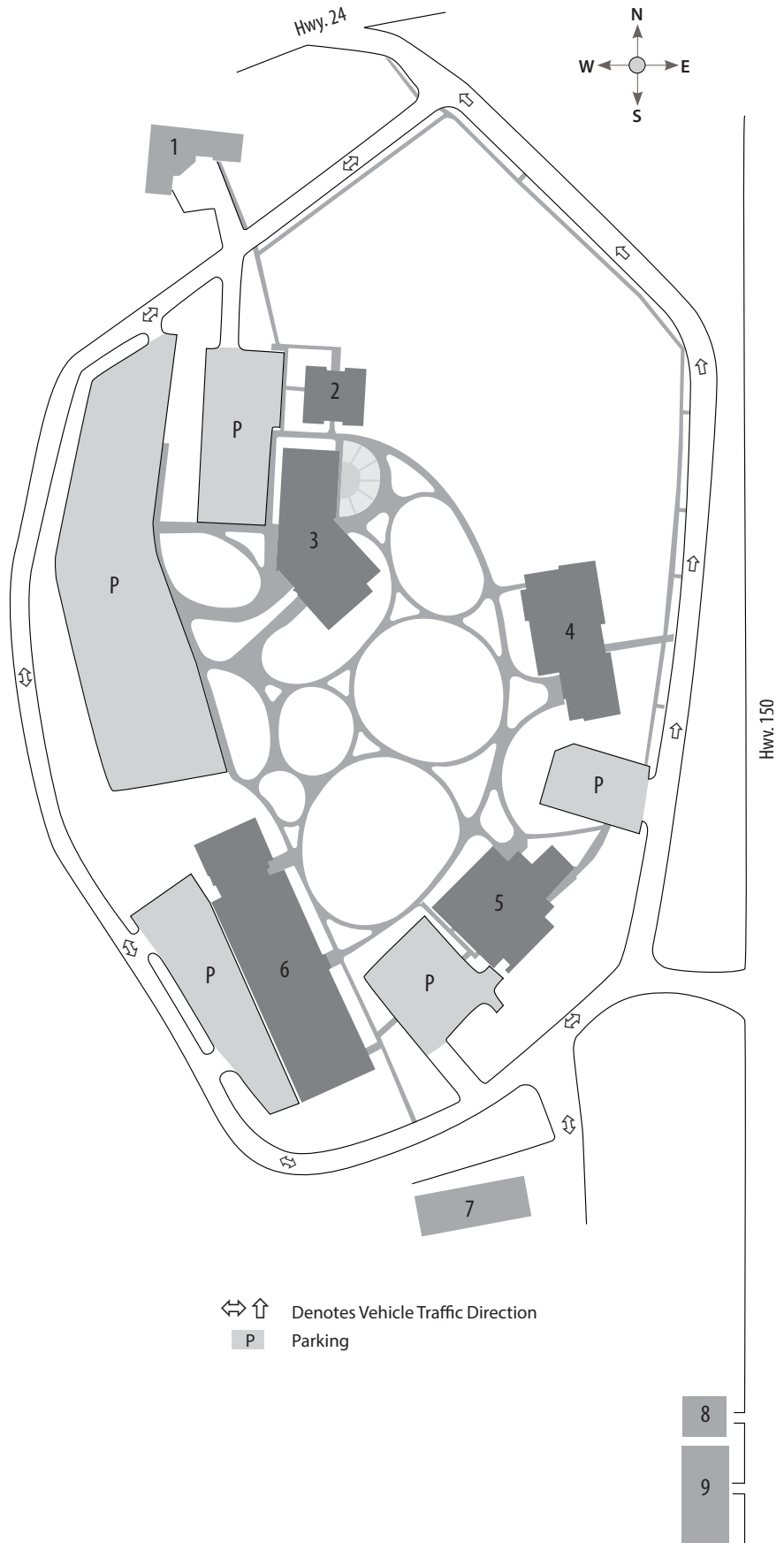

↔ ↑ Denotes Vehicle Traffic Direction
P Parking

**Northeast Iowa Community College
John Deere TECH Program**

Supervised Occupational Experience Training Agreement

By this agreement _____ (*John Deere Dealership*) agrees to permit _____ (*Student*) to enter its establishment for the purpose of securing on-the-job training as a Service Technician.

1. This agreement is valid for the two supervised occupational experience training semesters required for the John Deere TECH program. The student's work hours should coincide with the normal work hours of the business. The first on the job training will be _____ to _____. The second on the job training will be _____ to _____.
2. The trainee will be supervised in the field by _____.
3. Minimum wage must be paid during this time unless a higher wage is agreed upon between the student and the employer.
4. The training during the program shall be progressive. It shall provide for the trainee's passing from one experience to another in order that the trainee may become exposed to different phases of the occupation. Common safety practices shall be adhered to.
5. All complaints shall be made to and adjusted by the Ag Tech instructional staff.
6. The student may be dismissed for job failure at the employer's discretion.
7. No regular employee shall be laid off to make a place for a cooperative education employee.
8. It shall be agreed that parties participating in this program will not discriminate in employment opportunities on the basis of race, color, sex, national origin, handicap, or religion.
9. The student promises to abide by all implied and stated terms included in this agreement. The student shall be bound during the laboratory period by school regulations. The student shall be responsible for his/her conduct while in training.

Employer's Signature/Date

Student's Signature/Date

Instructor's Signature/Date

Northeast Iowa Community College provides equal opportunities for admission, employment and participation in programs and activities without regard to sex, race, age, disability, religion, marital status or national origin.

Northeast Iowa Community College John Deere TECH Program

Attendance Policy

Student attendance on a regular basis is a minimum expectation. While absences are evaluated on an individual basis, it is anticipated that students need to develop regular patterns of timeliness and attendance.

John Deere TECH students are preparing for full time careers in their chosen field. Regular class attendance is an important factor as the student prepares for the world of work. Future employers look at attendance very critically. The program has been designed to provide not only experiences that parallel future employment situations but also the theory that future technicians will need.

Therefore:

1. Attendance will be taken in every class at the established starting time.
2. If the student must be absent, they must inform the instructor in advance.
3. It is the responsibility of the student to make up all lost instructional time in cooperation with the instructor.
4. There are no automatic excused absences.
5. Since employers require regular attendance, students can anticipate that a pattern of tardiness or absences will result in a conference, during which the student will be expected to develop a plan to move to regular attendance. The absence of change on the student's part may result in student's loss of dealer sponsorship and removal from the program.
6. The student will not receive a permanent grade in a course until all assigned work is complete.

This class attendance policy is to assist the student in obtaining the best education possible. Northeast Iowa Community College, like your employer, is committed to the importance of regular attendance.

Cultivate good attendance habits. They are a major factor in retaining a position in industry.

I, _____, have read and understand the above attendance policy.